

# SNO DRIFT Rally

FEBRUARY 9-10 2024  
FRIDAY - SATURDAY



AMERICAN RALLY  
ASSOCIATION®

SPECTRUM . IMG

MONTMORENCY COUNTY

WWW.SNO-DRIFT.ORG

@SNODRIFTRALLY

REAL CARS ❄️ REAL ROADS ❄️ REAL FAST

# SNO DRIFT Rally



**TRIPLE-R**  
HIGH PERFORMANCE LIGHTING

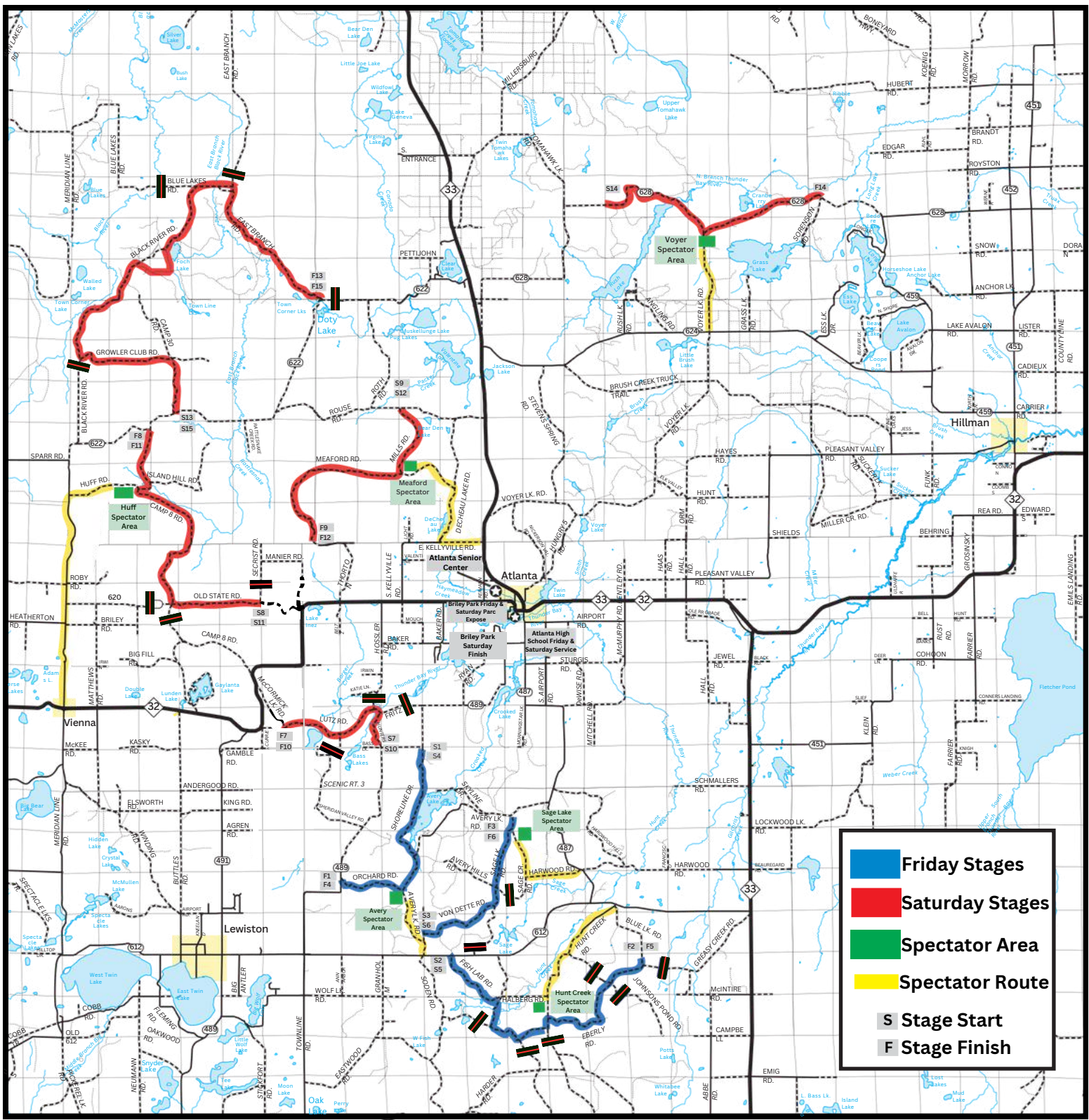

- Friday Stages
- Saturday Stages
- Spectator Area
- Spectator Route
- S** Stage Start
- F** Stage Finish





## **General Spectating Rules**

- ALL SPECTATORS TO PARK ON THE SAME SIDE OF THE ROAD – U-TURN AND PARK ON THE RIGHT FACING AWAY FROM THE SPECTATOR POINT**
- PARK FAR ENOUGH TO THE SIDE SO THAT THE ACCESS ROAD IS OPEN TO EMERGENCY VEHICLE TRAFFIC.**
- DO NOT BLOCK DRIVEWAYS OR PRIVATE ROADS**
- LISTEN TO ALL SNO\*DRIFT MARSHALS**
- DO NOT CROSS BARRICADES OR BANNER TAPES**
- DO NOT STAND ON THE OUTSIDE OF CORNERS, OR POSSIBLE OVERSHOOT AREAS**
- NEVER GET CLOSER THAN 50 FEET TO THE RACING CARS. IF POSSIBLE, SPECTATE FROM BEHIND TREES OR OTHER BARRIERS.**
- NO FIRES – RESPECT THE FOREST**
- LEAVE YOUR AREA CLEANER THAN YOU FOUND IT. USE THE TRASH RECEPTICLES.**
- CARS WILL ARRIVE AT APPROXIMATELY 1 MINUTE INTERVALS, BUT THERE COULD BE 5–10 MINUTES BETWEEN VEHICLES**
- STAGE IS “HOT” UNTIL SWEEP VEHICLES HAVE PASSED**  
(Sweep Vehicles will have yellow flashing lights on top of them)
- A STAGE IS OPEN TO TRAFFIC ONLY AFTER THE “GREEN LIGHT” VEHICLE PASSES THROUGH THE STAGE.**(It has green flashing lights on the roof)

# Directions to spectator area SS 1, 4 Avery Lake Rd and Orchard Rd Intersection

## **Spectator Area – Stage 1, 4 Avery Lake/Orchard Intersection**

N 44:55:00 W 84:08:33

Friday, February 9, 2024, 6:15 pm – 7:15 pm, 8:45 pm – 9:45 pm

From Atlanta: Starting at the intersection of M-32/33.

- Head South on CR 487 8.0 miles to Co Rd 612
- Turn Right onto Co Rd 612 (west) and travel 4.2 miles.
- Turn Right onto Avery Lake Rd (north) and travel 1.7 miles.

Please park on the west side of the road facing south

(You will need to turn around to park correctly)

Be Sure to Leave plenty of room for Emergency Vehicles to Enter and Exit.

# SS 1/4 – Shoreline – Orchard

## Intersection of Orchard and Avery Lake Roads

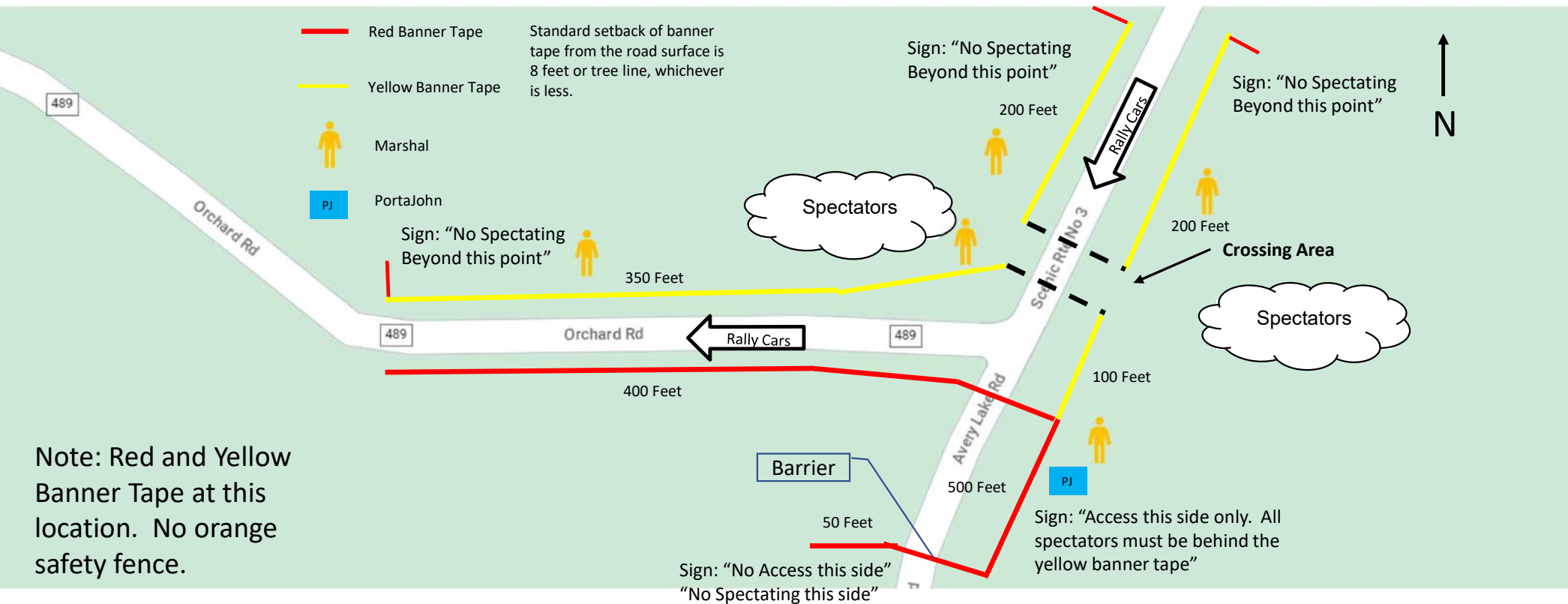

Note: Red and Yellow Banner Tape at this location. No orange safety fence.

Dedicated Parking:  
Medical, Radio, Crew,  
Law Enforcement

# Directions to spectator area SS 2, 5 Eberly and Hunt Creek Intersection

## **Spectator Area – Stage 2, 5 Eberly Hunt Creek Intersection**

N 44:51:41 W 84:07:53

Friday, February 9, 2024, 6:45 pm – 7:45 pm, 9:10 pm – 10:10 pm

From Atlanta: Starting at the intersection of M-32/33.

- Head South on CR 487 8.0 miles to Co Rd 612
- Turn Left onto Co Rd 612 (east) and travel .6 miles.
- Turn Right onto Hunt Creek Rd (south) and travel 3.5 miles.

Please park on the east side of the road facing north



(You will need to turn around to park correctly)

Be Sure to Leave plenty of room for Emergency Vehicles to Enter and Exit.

# Eberly – Hunt Creek Spectator Point Stages 2 and 5 Friday Evening

Note: Red and yellow Banner Tape at this location. No Orange Safety Fence.

Standard setback of banner tape from the road surface is 8 feet or tree line, whichever is less.

- Red Banner Tape
- Yellow Banner Tape
-  Marshal
-  Porta-John

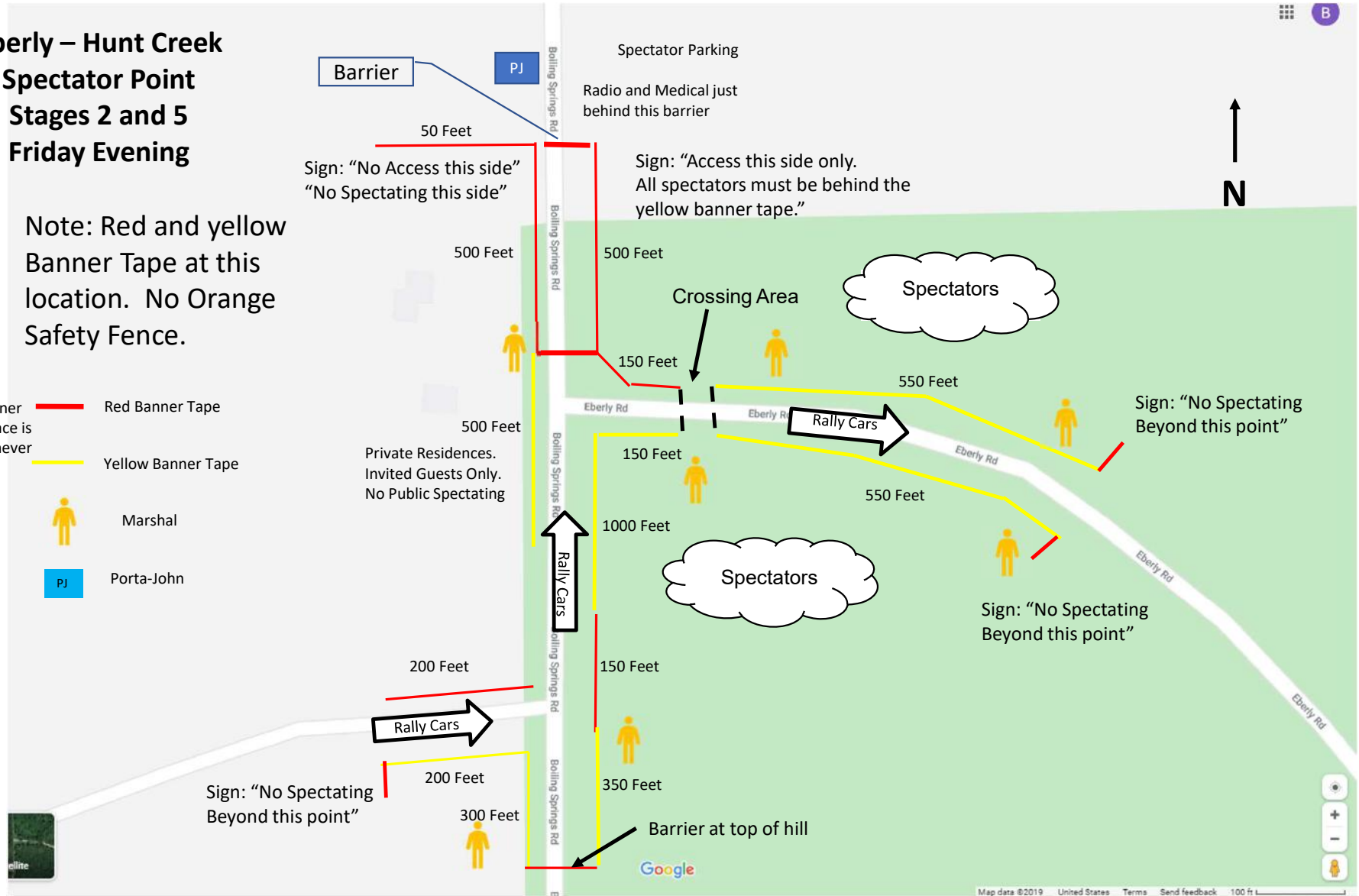

# Directions To Spectator Area SS 3, 6 Sage Lake And Sage Creek Intersection

## **Spectator Area – Stage 3, 6 Sage Lake/Sage Creek Intersection**

N 44:55:37 W 84:08:56

Friday, February 9, 2024, 7:15 pm – 8:15 pm, 9:45 pm – 10:45 pm

From Atlanta: Starting at the intersection of M-32/33.

- Head South on CR 487 7.5 miles to Harwood Rd
- Turn Right onto Harwood Rd (west) and travel 1.1 miles.
- Turn Right onto Sage Creek Rd (north) and travel 1.1 miles.

Please park on the west side of the road facing south

(You will need to turn around to park correctly)

Be Sure to Leave plenty of room for Emergency Vehicles to Enter and Exit.



# SS 3/6 – Sage/Von Dette

Put Barrier at CR 487 and Avery Lake to direct spectators to Harwood/Sage Creek for stage access

**Note: Red Banner Tape and Orange Safety Fence at this location.**

At end of safety fence, turn fence into woods to establish an end barrier.

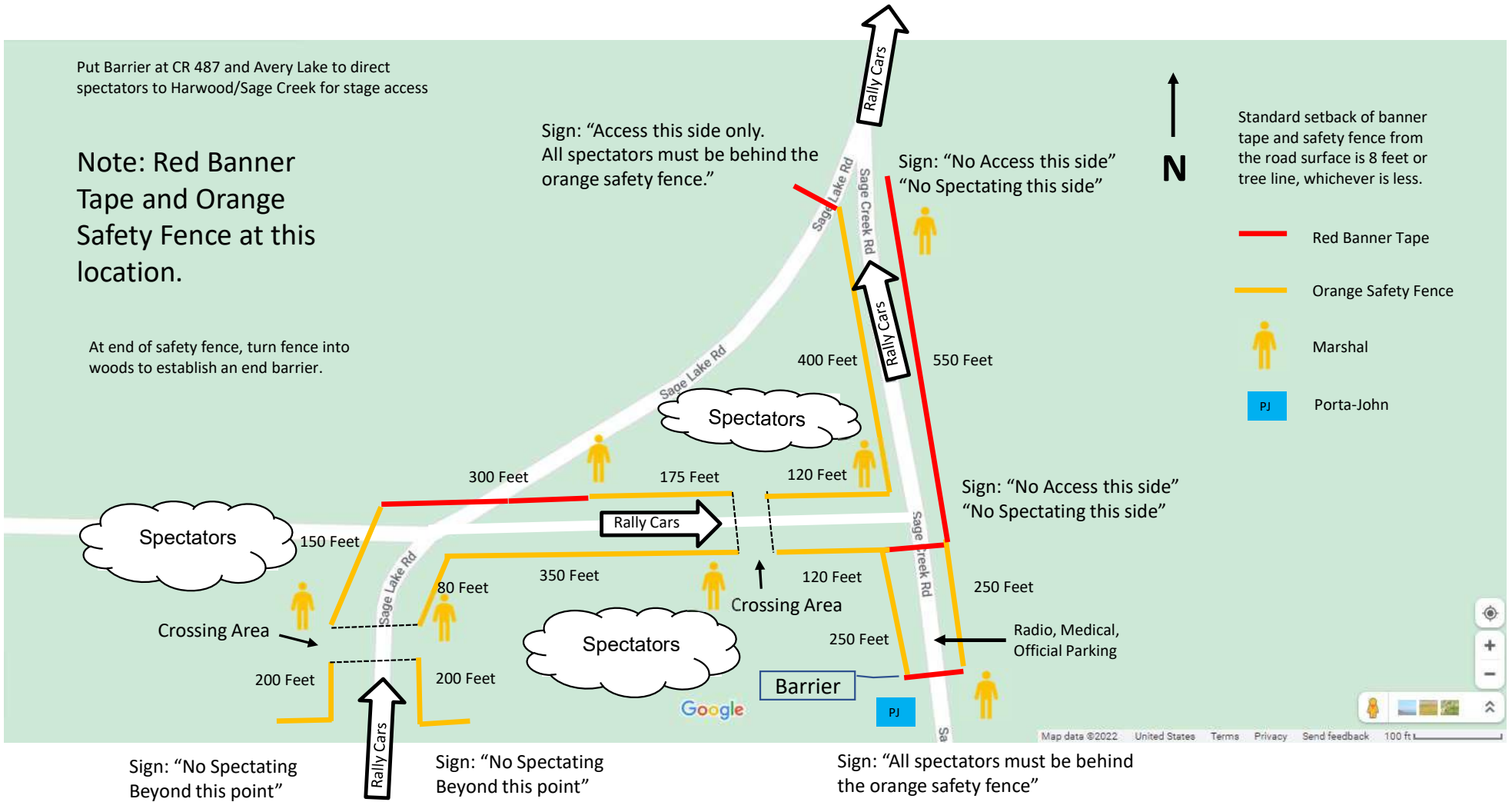

# Directions to spectator area SS 8, 11 Camp 8 and Huff Intersection

**Spectator Area – Stage 8, 11**

**Camp 8 and Huff**

N 44:51:41 W 84:07:53

Saturday, February 10, 2024, 12:45 pm – 1:45 pm, 3:15 pm – 4:15 pm

From Atlanta: Starting at the intersection of M-32/33.

- Head West on M-33 14.0 miles to Meridian Line Rd
- Turn Right onto Meridian Line Rd (north) and travel 5.3 miles.
- Turn Right onto Huff Rd (east) and travel 1.6 miles.

Please park on the north side of the road facing west

(You will need to turn around to park correctly)

Be Sure to Leave plenty of room for Emergency Vehicles to Enter and Exit.

# Old State – Huff Spectator Area Stages 8 and 11 Saturday Afternoon

Note: Red and Yellow Banner Tape at this location. No orange safety fence.

- Red Banner Tape
- Yellow Banner Tape
-  Marshal
- PJ Porta-John

Standard setback of banner tape from the road surface is 8 feet or tree line, whichever is less unless noted.

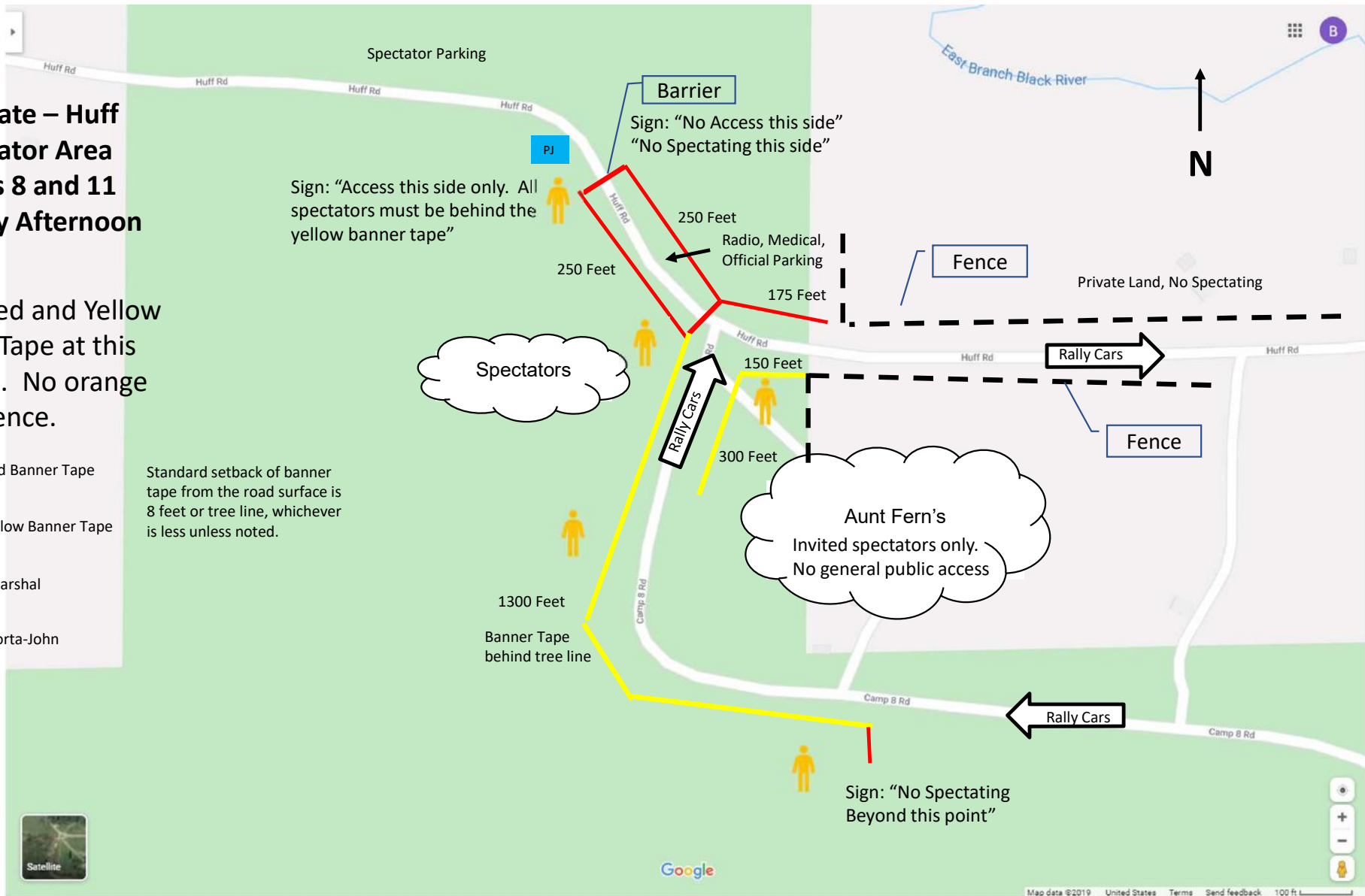

# Directions to spectator area SS 9, 12 Meaford and Mills Intersection

## **Spectator Area – Stage 9, 12**

### **Meaford and Mills**

N 45:03:07 W 84:12:13

Saturday, February 10, 2024, 1:15 pm – 2:15 pm, 3:50 pm – 4:50 pm

From Atlanta: Starting at the intersection of M-32/33.

- Head North on M-33 2.0 miles to Kellyville Rd
- Turn Left onto Kellyville Rd (west) and travel 1.1 miles.
- Turn Right onto DeCheau Rd (north) and travel 1.4 miles.
- Turn Left onto Meaford Rd (west) and travel 1.5 miles to the Spectator Area.

Please park on the south side of the road facing east



(You will need to turn around to park correctly)

Be Sure to Leave plenty of room for Emergency Vehicles to Enter and Exit.

# Mills - Meaford Spectator Area

## Stages 9 and 12 Saturday Afternoon

Standard setback of banner tape from the road surface is 8 feet or tree line, whichever is less unless noted.

- Red Banner Tape
- Yellow Banner Tape
-  Marshal
-  PortaJohn

Note: Red and Yellow Banner Tape at this location. No orange safety fence.

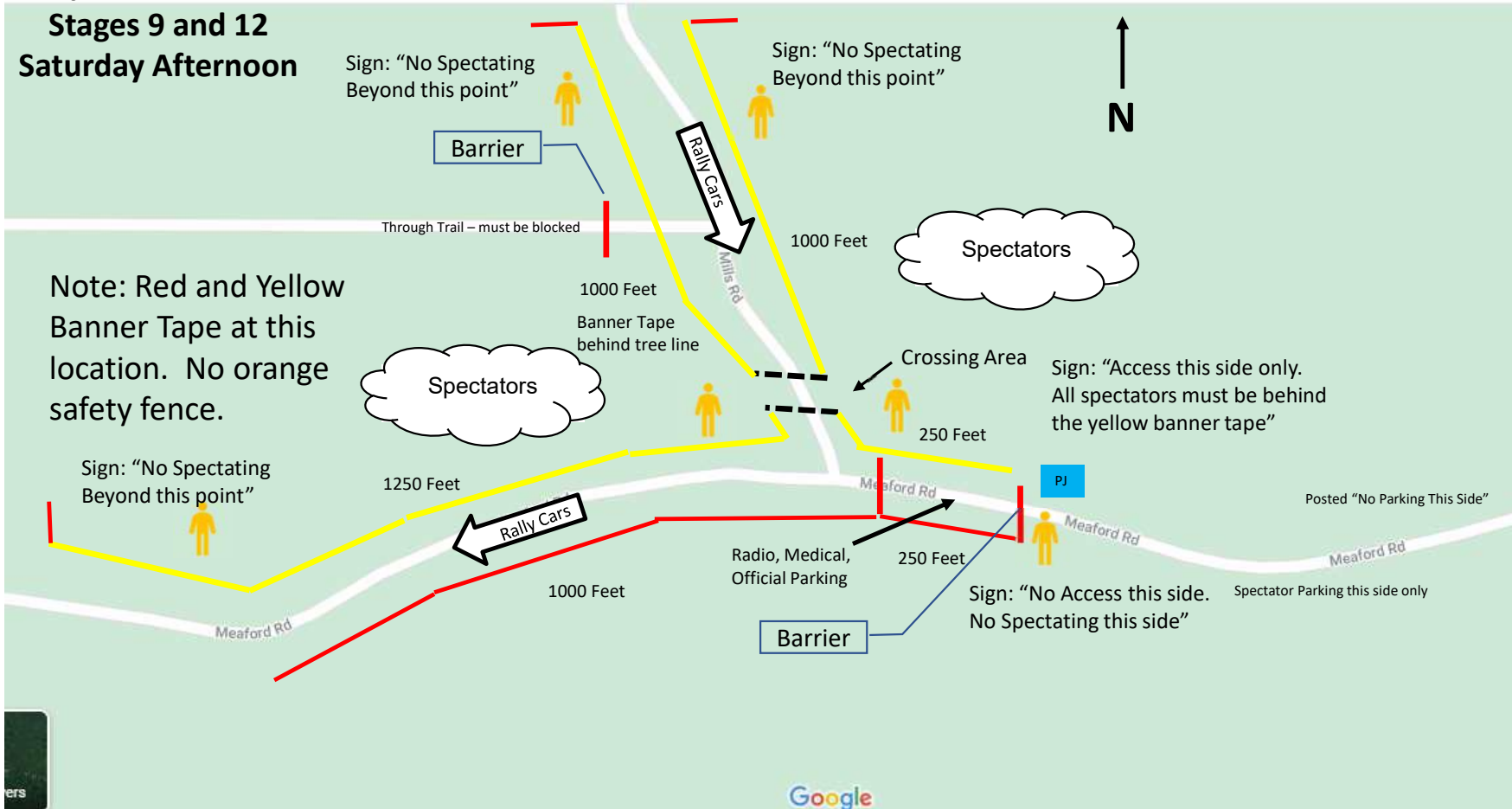

# Directions to spectator area SS 14 Voyer Lake and CR 628 Intersection

## **Spectator Area – Stage 14**

### **Voyer Lake and CR 628**

N 45:08:09 W 84:03:16

Saturday, February 10, 2024, 6:25 pm– 7:25 pm

From Atlanta: Starting at the intersection of M-32/33.

- Head North on M-33 6.0 miles to Co Rd 624
- Turn Right onto CO Rd 624 (east) and travel 5.5 miles.
- Turn Left onto Voyer Lake Rd (east) and travel 2.7 miles.

Please park on the west side of the road facing south

(You will need to turn around to park correctly)

Be Sure to Leave plenty of room for Emergency Vehicles to Enter and Exit.

# Thunder River Spectator Area Stage 14 Saturday Evening

Note: Red Banner Tape only at this location. Orange safety fence as shown via orange lines.

Orange safety fence extends 1250 feet in both directions from the intersection. At end of safety fence, turn fence into woods to establish an end barrier.

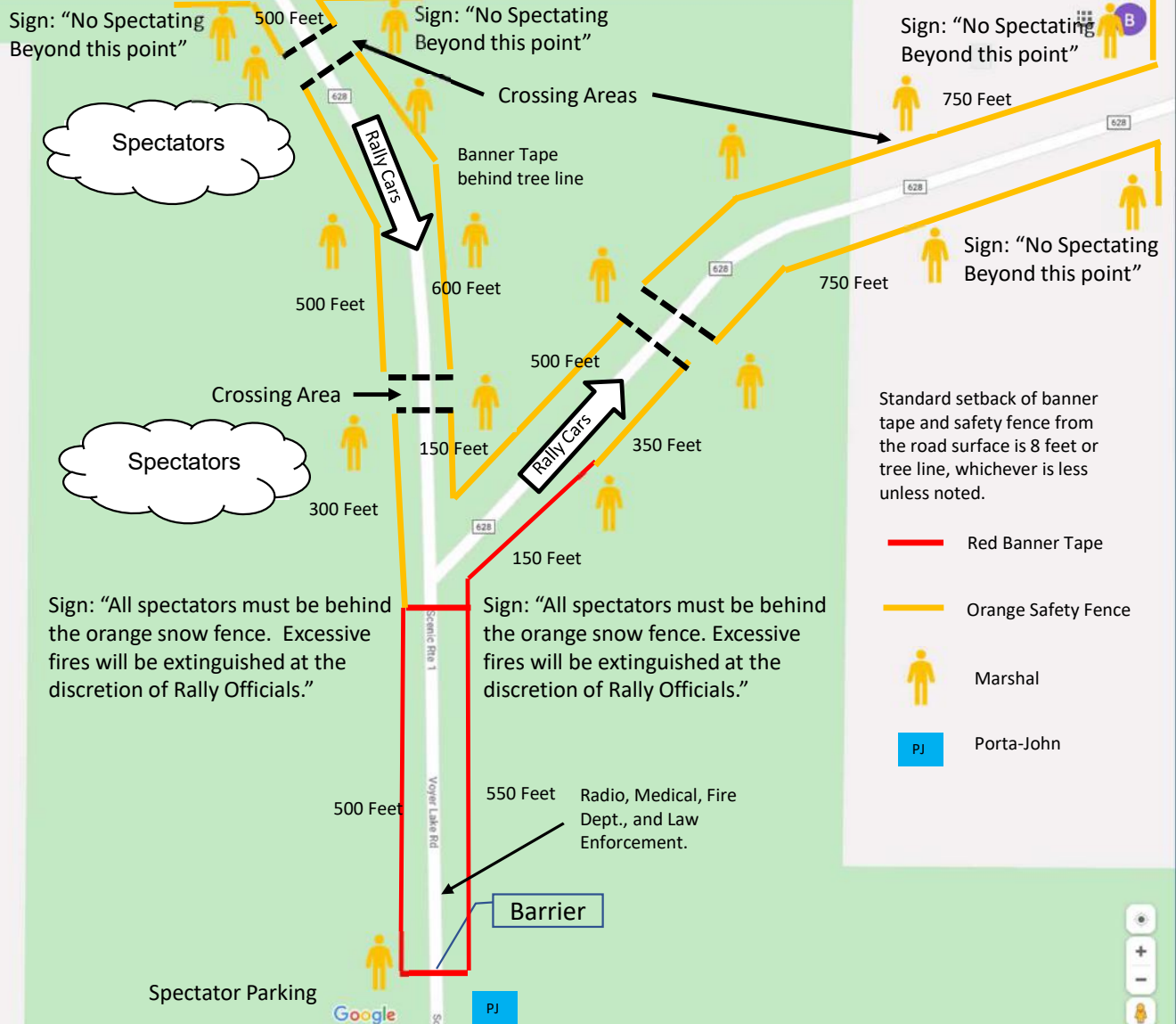

# TRIPLE-R

HIGH PERFORMANCE LIGHTING

# SEE MORE GO FURTHER GO SAFER



TRIPLE-R-LIGHTS.COM



# 2024 Sno\*Drift

## Road Closure and Traffic Control Schedule

Name and Section of Road		Traffic Controlled Access Restricted	Road Closed Cars Competing 1st Running	Road Closed Cars Competing 2nd Running
<b>Wednesday, February 7, 2024</b>				
Elk Valley Rd.	from Voyer Lake Rd to Orm Rd		7:00 AM - 7:00 PM	
Hardwood Hills Rd.	from Harwood Rd to Landfill Rd			
Hungry 5 Rd.	From Voyer Lake Rd to Nickerson Valley Rd			
Avery Hills Rd	from Sage Creek Rd to Sage Lake Rd			
<b>Friday, February 9, 2024</b>				
Park St.	from Co. Rd. 487 to West St.	closed for car display and control ops 3:00 PM - 8:00 PM		
Parland St.	South of M-32			
Shoreline Rd.	from Co 489 to Avery Lake Rd	5:15 PM - 10:15 PM	6:00 PM - 7:30 PM	8:15 PM - 9:45 PM
Avery Lake Rd.	from Shoreline Rd to Orchard Trail Rd			
Orchard Trail Rd	from Avery Lake Rd. to Co 489	Spectator parking, limited access, no through traffic		
Avery Lake Rd	South of Orchard			
Blue Lake Rd.	from Greasy Creek Rd to Eberly Rd.	5:45 PM - 10:45 PM	6:30 PM - 8:00 PM	8:45 PM - 10:15 PM
Eberly Rd.	from Blue Lake Rd. to Hunt Creek Rd.			
Hunt Creek Rd.	from East Fish Lake Rd. to Eberly Rd.			
East Fish Lake Rd.	from Soden Rd to Hunt Creek Rd.			
Soden Rd.	from Co 612 to East Fish Lake Rd.			
Hunt Creek Rd.	North of Eberly	Spectator parking, limited access, no through traffic		
Sage Ck Rd.	from Avery Lake Rd to Sage Lake Rd	6:15 PM - 11:15 PM	7:00 PM - 8:30 PM	9:15 PM - 10:45 PM
Sage Lake Rd.	from Avery Lake Rd to Vondette Rd.			
Quinnan Rd.	from Avery Lake Rd to Quinnan Rd			
Vondette Rd.	from Sage Lake Rd to Quinnan Rd			
Sage Ck Rd.	South of Sage Lake Rd	Spectator parking, limited access, no through traffic		
<b>Saturday, February 10, 2024</b>				
Park St.	from Co. Rd. 487 to West St.	closed for car display 7:00 AM - 11:00 AM		
Parland St.	South of M-32			
McCormick Lake Rd.	from Lutz Rd. to .2 mile N of Lutz Rd	11:15 AM - 4:15 PM	12:00 PM - 1:30 PM	2:15 PM - 3:45 PM
Lutz Rd.	from Fritz Rd. to McCormick Lake Rd.			
Fritz Rd.	from Hunters Rd. to Lutz Rd.			
Hunters Rd.	from Co 489 to Fritz Rd.	11:45 AM - 5:00 PM	12:30 AM - 2:00 PM	3:00 PM - 4:30 PM
Huff Rd.	from Camp 8 Rd. north to Co. Rd. 622			
Camp 8 Rd.	from Old State Rd. to Huff Rd.			
Old State Rd.	from Camp 8 Rd to Manier Rd.	Spectator parking, limited access, no through traffic		
Huff Rd.	from Camp 8 Rd. west to Co. Rd. 622	12:15 PM - 5:30 PM	1:00 PM - 2:30 PM	3:30 PM - 5:00 PM
Meaford Rd.	from Mills Rd. to Thornton Rd.			
Mills Rd.	from Meaford Rd. to Rouse Rd.			
Meaford Rd.	from DeCheau Lk Rd to Mills Rd	Spectator parking, limited access, no through traffic		
East Branch Rd.	from Blue Lakes Rd. to Co. Rd. 622	4:00 PM - 10:30 PM	5:00 PM - 7:00 PM	7:45 PM - 9:45 PM
Blue Lakes Rd.	from Black River Rd. to East Branch Rd.			
Black River Rd.	from Growler Club Rd. to Blue Lakes Rd.			
Cutover Rd.	from Townline Rd. to Black River Rd.			
Townline Rd.	from Black River Rd. to Cutover Rd.			
Growler Club Rd.	from Camp 30 Rd. to Black River Rd.			
Camp 30 Rd.	from Co. Rd. 622 to Growler Club Rd.	5:00 PM - 8:00 PM	6:00 PM - 7:30 PM	NA
Co. Rd. 628	from 1 mi. East of Tomahawk Lk. Rd. to Sorenson Rd.			
Voyer Lake Rd	from Co Rd 624 to Co Rd 628	Spectator parking, limited access, no through traffic		



AVAILABLE  
@ SNO\*DRIFT

ARA Trailer during Expose and Podium - Also available at the RallySuperStore

**ARA** AMERICAN RALLY ASSOCIATION

CATCH A GREAT  
MOMENT?  
SHARE IT HERE!



**DirtFish**  
LIVE CENTER



43i IS GIVING BACK TO THE RALLY COMMUNITY WITH THE  
KEN BLOCK FLAT OUT 43VER AWARD

43 INSTITUTE CREATED THE KEN BLOCK FLAT OUT 43VER AWARD HONORING KEN'S LOVE AND ONGOING COMMITMENT TO THE SPORT OF RALLY AND THE RALLY COMMUNITY. THIS AWARD WILL BE GIVEN OUT AT EACH REMAINING ARA NATIONAL EVENTS OF THE 2024 SEASON. THIS AWARD WILL RECOGNIZE TEAMS DISPLAYING KEN'S JUST AIN'T CARE ATTITUDE, PRESS ON REGARDLESS MINDSET, AND/OR FLAT OUT COMMITMENT DURING THE EVENT. THE DRIVER AND CO-DRIVER AWARDED WILL EACH RECEIVE A PRIZE OF \$1,430.00.

WHO'S GOING TO WIN?

BLOCK  
HOUSE  
RACING

43i.ORG

**ARA**  
AMERICAN RALLY  
ASSOCIATION

**2024**  
NATIONAL  
CHAMPIONSHIP

- FEB 9-10 SNO\*DRIFT RALLY
- MAR 15-16 RALLY IN THE 100 ACRE WOOD
- APR 20-21 OLYMPUS RALLY
- MAY 17-19 OREGON TRAIL RALLY
- JUN 6-8 SOUTHERN OHIO FOREST RALLY
- AUG 23-24 OJIBWE FORESTS RALLY
- SEP 14-15 OVERMOUNTAIN RALLY TENNESSEE
- OCT 11-12 LAKE SUPERIOR PERFORMANCE RALLY



# LOCAL IMPACT

## Impact on Local Businesses

Sno\*Drift continues to bring around 2,000 people into Montmorency County and the surrounding areas. This year, we are expecting more than 40 teams consisting of two competitors plus their service crew (often three or more). And it takes around 250 volunteer workers to make a rally run smoothly.

All lodgings in Montmorency County fill rather quickly for this event and people are now being referred to Gaylord, Alpena, Onaway, Mio, Rose City, and West Branch for additional lodging. Additionally, many residents are renting, either lodgings or garage space, which is much desired by the rally teams.



## Residents

In cooperation with the Montmorency County Road commission and the County Sheriff's Office, Sno\*Drift makes a commitment to contact residents/property owners along the roads being closed for special stages to explain the event and obtain signatures of approval. Residents are given specific times that their roads are expected to be closed and roads themselves are posted with those times. Sno\*Drift has found that most residents are very excited to have the rally come to town – it's free entertainment at the foot of their driveway.



## Communications

Volunteer Ham Radio Operators provide communications for the rally. Any licensed Ham Radio Operators interested in participating should contact us by email:

[snodriftweb@gmail.com](mailto:snodriftweb@gmail.com)



# REMEMBERING OUR RALLY FAMILY



Henry L. Krolkowski  
1951-2019



Donald G. Rathgeber  
1939-2020



Allan J. Dantes Jr.  
1979-2022



James S. Monks Jr.  
1973-2022

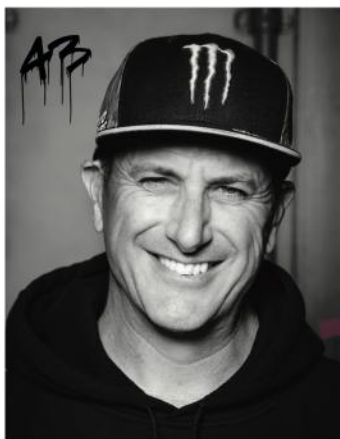

Ken Block  
1967-2023



Kubo Kordisch  
1981-2023

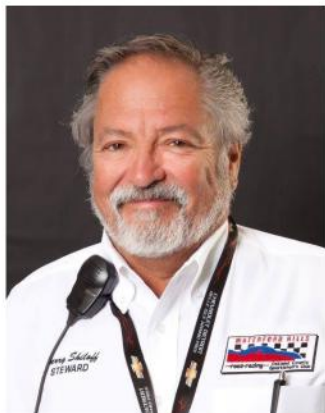

Jerry Shiloff  
1946-2023



Neil Thomas  
1991-2023



Erin Kelly  
1975-2023



# GOT PICTURES?

If you have a good picture from Sno\*Drift and want to share with us, send it to:

**SnoDriftSpecGuide@gmail.com**

It doesn't have to be a picture of a car, but it does have to be from Sno\*Drift. If we like it, you may see it in next year's Sno\*Drift Spectator Guide.



GPS, Google Maps, etc. are **NOT** the best way to the spectator sites.

Please follow the route instructions given in the spectator guide to the various spectator points.

GPS or mapping software may show a shorter and or faster route. However, what it doesn't show is if the route uses roads that may be closed to through traffic for the rally.

Check the Internet to get the latest information, scores, results, reports, interviews, and pictures. Everything will be posted to the web before, during, and after the rally at [www.sno-drift.org](http://www.sno-drift.org)

## Spectator Guide Cover Photo

If your picture of this year's Sno\* drift rally winner is selected for next year's cover, you'll be eligible for an all access "**SUPER SPECTATOR**" pass for next year's event

If you send it to us, it is ours and your compensation is seeing it in print with a credit



## ***SUBARU SPECIALISTS***

***Accelerated Kontrol Dynamics, serving Michigan and the Midwest region with exceptional automotive service and competition performance for your Subaru.***

### ***A NOTE FROM ADAM-***

*We all love these cars- it's what gathers us to special events like Sno\*Drift. We love watching our friends, family, and everyone enjoy; whether spectating or competing! The team at AKD is proud and dedicated to continually support this event, its competitors, and its volunteers & staff in achieving an exceptional race environment.*

*Adam Darts*

### ***INFO-***

***248-396-0817***

***5275 Dixie Hwy Suite C-6***

***Waterford, Mi 48329***

### ***FOLLOW US!***

*Facebook- Accelerated Kontrol Dynamics LLC Instagram- @accelerated\_kontrol\_dynamics\_*





**Spectator Schedule Sno\*Drift Rally February 9 & 10, 2024**

Spectator Area	Location	Special Stage #	Road Closed to Public	First Car Start Time	Last Car Finish Time (MAX)	Road Open to Public (Time APPROXIMATE See Note*)
<b>Friday February 9</b>						
Parc Expose & Ceremonial Start	Downtown Atlanta, Briley Township Park	Rally cars will be available for viewing between 4:15 PM and 7:00 PM				
		6:00 PM Ceremonial Start				
	SHORELINE - ORCHARD	1	5:15 PM	6:15 PM	7:15 PM	10:45 PM
	BLUE LAKE - SODEN	2	5:45 PM	6:45 PM	7:45 PM	11:10 PM
	VON DETTE - SAGE CREEK	3	6:15 PM	7:15 PM	8:15 PM	11:45 PM
	SHORELINE - ORCHARD	4	5:15 PM	8:45 PM	9:45 PM	10:45 PM
	BLUE LAKE - SODEN	5	5:45 PM	9:10 PM	10:10 PM	11:10 PM
	VON DETTE - SAGE CREEK	6	6:15 PM	9:45 PM	10:45 PM	11:45 PM
<b>Saturday February 10</b>						
Parc Expose & Ceremonial Start	Downtown Atlanta, Briley Township Park	Rally cars will be available for viewing between 10:30 AM - 1:00 PM				
		12:00 PM Ceremonial Start				
	HUNTERS - MCCORMICK	7	11:20 AM	12:20 PM	1:20 PM	4:50 PM
	OLD STATE - HUFF	8	11:45 AM	12:45 PM	1:45 PM	5:15 PM
	MILLS - MEAFORD	9	12:15 PM	1:15 PM	2:15 PM	5:50 PM
	HUNTERS - MCCORMICK	10	11:20 AM	2:50 PM	3:50 PM	4:50 PM
	OLD STATE - HUFF	11	11:45 AM	3:15 PM	4:15 PM	5:15 PM
	MILLS - MEAFORD	12	12:15 PM	3:50 PM	4:50 PM	5:50 PM
	CAMP 30 - EAST BRANCH	13	4:40 PM	5:40 PM	6:40 PM	10:35 PM
	THUNDER RIVER	14	5:25 PM	6:25 PM	7:25 PM	8:25 PM
	TRIPLE-R POWER STAGE	15	4:40 PM	8:35 PM	9:35 PM	10:35 PM

\*The road is open to the public ONLY AFTER THE GREEN LIGHT vehicle passes through. The GREEN LIGHT vehicle is marked with GREEN LIGHTS. If the stage is run back-to-back, the Green Light Vehicle only comes through at the end of the second running, opening the roads to the public.

**Amateur Radio Frequencies:**

The following Ham Radio Frequency will be utilized by the Sno\*Drift Organizing Committee for voice communications during this year's Sno\*Drift Rally. Both are found on the 2-meter band.

**146.70 MHz will be the Primary Repeater for Friday and Saturday.**

Net Control will have a link to GRLevel3 Weather Radar and will report any significant weather-related updates from the National Weather Service on the rally frequencies being utilized.



# TRIPLE-R

HIGH PERFORMANCE LIGHTING



**SEE MORE  
GO FASTER  
GO SAFER**

[TRIPLE-R-LIGHTS.COM](http://TRIPLE-R-LIGHTS.COM)

Entry list as  
of 1/27/2024



	Category	Class	Car	Driver	Codriver	Car Model
1	National	O4WD	1	Brandon Semenuk	Keaton Williams	Subaru WRX ARA24
2	National	O4WD	199	Travis Pastrana	Rhianon Gelsomino	Subaru WRX ARA24
3	National	L4WD	192	Javier Olivares	KJ Miller	2021 Ford Fiesta
4	National	RC2	136	Enda McCormack	Liam McCormack	2022 Hyundai i20 N Rally2
5	National	O4WD	252	Jerome Mailloux		
6	National	NA4WD	35	Mark Piatkowski	Aris Mantopoulos	1999 Subaru Impreza 2.5RS
7	National	L4WD	42	Jason Bailey	Jamie Willetts	2013 Ford Fiesta
8	East Regional	NA4WD	777	Jon Kramer	Jason Smith	
9	East Regional	L4WD	711	John farrow	Mike Farrow	2002 Subaru Impreza WRX
10	East Regional	L4WD	887	Jimmy Pelizzari		2000 Subaru Impreza
11	National	L4WD	98	Ele Bardha	Corrina Roshea	2000 Subaru Prodrive GC8
12	East Regional	L4WD	170	Nick Balzer	Jon Schrage	2004 Subaru WRX Wagon
13	National	L2WD	305	Santiago Iglesias	Robert Kassel	2013 Subaru BRZ
14	East Regional	L4WD	429	Scott Crouch	Ryan Scott	2002 Subaru WRX
15	National	L2WD	232	Mark Tabor	Kathryn Hansen	2015 Ford Fiesta ST
16	East Regional	O2WD	36	Michael Cessna	Jamie Lambert	1998 BMW M3
17	East Regional	NA4WD	880	Taylor Hoevenaar	Steven Stewart	1999 Subaru Forester
18	East Regional	L4WD	69	Gabe Jacobsohn		
19	East Regional	O2WD	201	Adam VanDamme		1985 Volkswagen Golf
20	East Regional	L4WD	432	Tom Mayer	Karl Mayer	2002 Subaru WRX
21	National	L4WD	418	Tim Wickberg	Bryce Proseus	2013 Subaru Impreza WRX STi
22	National	L2WD	126	Sean Donnelly	Zach Pfeil	2015 Ford Fiesta ST
23	East Regional	NA4WD	353	Dan Shirley	Nathan Lybarger	2005 Subaru Impreza OBS
24	East Regional	L4WD	993	Mike Tirpak	Nick Luther	1993 Ford Escort RS Cosworth
25	East Regional	L2WD	986	Chris Nonack	Sara Nonack	2013 Subaru BRZ
26	National	O2WD	609	Keenan Phillips	Salina Melotti	1997 BMW 328i
27	East Regional	L4WD	597	Rob Dupree	Mike Funk	1991 Mitsubishi Eclipse GSX
28	East Regional	O2WD	990	Sean Burke	Drake Burke	1991 Honda CRX
29	East Regional	O2WD	912	Scott James	Michelle Donovan	2008 Volkswagen GTI
30	National	L2WD	191	Alastair Scully	Alex Gelsomino	2016 Ford Fiesta ST
31	East Regional	NA4WD	262	Camden Sheridan	Jeremy Frey	1999 Subaru Impreza
32	East Regional	NA4WD	211	Jack Nelson	Isaac Zink	2000 Subaru Impreza
33	East Regional	NA4WD	518	Andrew Williamson	Julia Stewart	1993 Subaru Impreza
34	East Regional	L2WD	412	Alan Edwards	Daniel Baker	2003 Dodge Neon
35	National	NA4WD	747	Andy Didorosi	Stefan Trajkov	1998 Subaru Impreza
36	East Regional	L2WD	603	Heath Shively	Elena Huizar	1985 Volkswagen Golf
37	National	L2WD	488	John Sharps		
38	National	NA4WD	209	Madelyn Tabor	Sophia McKee	1999 Subaru Impreza 2.5RS
39	East Regional	O4WD	810	Bradley Hayosh	Neil Moser	2002 Subaru Impreza STi
40	East Regional	L2WD	300	Chase Blakely	Michael Callaway	2000 Volkswagen GTI GLX
41	National	O2WD	552	Doug E Shepherd	Cynthia Krowlikowski	2003 Dodge SRT4
42	East Regional	L2WD	617	Phillip Giliver	Elizabeth Cordara	2006 Toyota Yaris
43	National	L4WD	166	Haowen Chu	Roderik Jones	

# HELP WANTED

## VOLUNTEER

Sno\*Drift is always looking for people to volunteer. Without you, the event wouldn't be possible!

### INSIDE

Help with registration at the desk!

### RADIO

Licensed ham radio operators are always in demand. You're especially valuable if you have a mobile 2M in a 4WD/AWD vehicle!



Scan to sign up to volunteer!

### FIELD WORK

Work as a stage marshal or as a spectator safety marshal

### SKILLED LABOR

Licensed ham radio operators are always in demand. You're especially valuable if you have a mobile 2M in a 4WD/AWD vehicle



Henry Roeters Photo



### REGISTRATION SCHEDULE

Thursday February 8 - 2:00pm - 9:00pm

Friday February 9 - 9:00am - 2:00pm

### REGISTRATION LOCATION:

### ATLANTA SENIOR CENTER

Starting from from the intersection of M-32 & M-33, 1/2 mile north, on the left, on M-33

Family. Wedding. Portrait. Event. Automotive.

# TESSA HACKER Photography



Scan for  
Sno\*Drift  
Photos!



TessaHackerPhoto.com

# WHAT IS RALLY

## RALLY

Rally is a flat-out competition over closed sections of rural roads by modified production automobiles. It is different than most car races in that:

- Competitor's race one car at a time against the clock, usually at one-minute intervals
- Competition is done on limited access roads, blocked off from "civilian" traffic, rather than on prepared tracks
- Events can be several hundred miles long, often lasting for several days.
  - Each car has a driver and a co-driver/navigator
- In-between competition stages, the cars travel over public roads and are required to obey all traffic laws

## CAR CLASSES

AWD/4WD: Open, NA-4WD, Limited-4WD, RC2  
2WD: Open, Limited

Most popular are small American and imported sedans such as: Subaru, Dodge, Audi, Ford, VW, Hyundai, Mazda, Mitsubishi, and Toyota. The endurance required for performance rally makes it an excellent showcase for manufacturers!



## EVENTS

The American Rally Association Championship consists of several events held throughout the United States. Sno\*Drift is the first national rally of the American Rally Association Championship series. Most National Rally events feature one Regional Rally event enabling the entry level or regional performance rallyist to run directly against the national series teams. There are also several stand-alone regional rallies in the series.

Each team is given a route book just prior to the start of the event that describes the course in detail with diagrams of turns, notations of water crossing, jumps, and spectators, etc. The co-driver (navigator) uses this book along with stage notes supplied through the event, local maps, odometers, and special equipment, even computers to keep the driver on course and on time. Transit sections are sections of the event in which the team travels to get from the finish of one stage to the start of the next stage in modified production vehicles (street legal). Special Stages are where the real competition takes place. The roads are usually unpaved or seasonal roads, logging trails, mountain roads, or desert tracks. Checkpoints and traffic controls close all "civilian" access to the stages. The cars arrive at the "Arrival Time Control" or "ATC" and leave in one-minute or two-minute intervals, depending on road and weather conditions, and the team's ranking. The time it takes the competitors to reach the "Finish Time Control" or "FTC" is accurately measured. A transit section takes them to the next ATC. At the end of the rally, all the stage times are added up and the fastest car wins.

That's what its all about!

TEAM ILLUMINATA MOTORSPORT

TIM



teamilluminata.com

MOTUL



RENLINE

BRAID

FINISH LINE FACTORY

BRAID  
#PROPERWHEELS

CORBEAU  
SEATS

WANT RACECAR PARTS?

HOBNOBS

RALLY  
CARS

Better  
call  
Paul!

ANSWERS  
THE  
PHONE

YORKSHIRE  
TEA

ACTUALLY  
CARES

MOTUL



paul@teamilluminata.com | Teamilluminata.com | 248.207.0894

# SNO\*DRIFT

# 2023 NATIONAL RESULTS

Overall	In Class	Category	Class	Number	Driver	Codriver	Car	Total
1	1	National	O4WD	1	Brandon Semenuk	Keaton Williams	2021 Subaru WRX STI	1:56:47.9
2	1	National	RC2	688	Tom Williams	Ross Whittock	2022 Ford Fiesta	2:10:14.1
3	2	National	RC2	18	Kyle Tilley	Martin Brady	2021 Hyundai i20N	2:11:09.1
4	3	National	RC2	243	Patrick Gruszka	Florian Barral	2019 Hyundai I20	2:13:32.3
5	1	National	L4WD	489	Matthew Dickinson	Chris Kremer	2015 Subaru WRX STi	2:14:44.2
6	2	National	L4WD	875	Vincent Trudel	Michael Szewczyk	2011 Subaru Impreza Sti	2:19:16.1
7	4	National	RC2	398	Ricardo Cordero	Marco Hernandez	2018 Citroen C3	2:21:26.5
8	1	National	O2WD	237	Micah Nickelson	Tyler Ptacek	1986 Volkswagen Golf	2:29:06.1
9	1	National	NA4WD	880	Tayler Hoevenaar	Steven Stewart	1999 Subaru Forester	2:29:15.6
10	3	National	L4WD	42	Jason Bailey	Jamie Willetts	2013 Ford Fiesta	2:31:07.2
11	2	National	O2WD	84	Nick Allen	Matt James	2016 Ford Fiesta	2:41:37.3
12	4	National	L4WD	747	Andy Didorosi	KJ Miller	1998 Subaru Impreza	2:48:13.4
13	2	National	NA4WD	35	Mark Piatkowski	Aaron Crescenti	1999 Subaru Impreza 2.5RS	2:54:22.8
14	1	National	L2WD	996	Gerardo Hernandez	Keegan Helwig	2019 Mazda 2 Rally5	2:57:35.6
15	2	National	L2WD	305	Santiago Iglesias	Robert Kassel	2013 Subaru BRZ	3:05:17.8
		National	L4WD	98	Ele Bardha	Corrina Roshea	2000 Subaru Prodrive GC8	2:26:29.7
		National	O4WD	252	Jerome Mailloux	Philippe Poirier	2010 Subaru STi	1:56:51.6
		National	L4WD	488	John Sharps	Weston Davis	2022 Honda Passport	1:23:11.5
		National	L2WD	33	Josh Armantrout	Travis Hinkle	2016 Ford Fiesta ST	1:08:47.1



# SNO\*DRIFT

# 2023 REGIONAL RESULTS

Overall	In Class	Category	Class	Number	Driver	Codriver	Car	Total
1	1	Regional	O4WD	887	Jimmy Pelizzari	Kate Stevens	2000 Subaru Impreza STi	2:01:46.6
2	1	Regional	NA4WD	927	Tim Michel	Cindy Krolikowski	1996 Audi A4 quattro	2:07:04.7
3	2	Regional	NA4WD	676	Sam Jacques	Trevor Lacombe	2009 Subaru Impreza	2:10:28.2
4	3	Regional	NA4WD	777	Jon Kramer	Jason Smith	2000 Subaru Impreza 3.0RS	2:11:09.7
5	4	Regional	NA4WD	409	Dylan Gondyke	Ben Chuong	1998 Subaru Impreza	2:12:10.8
6	5	Regional	NA4WD	353	Dan Shirley	Nathan Lybarger	2005 Subaru Impreza OBS	2:12:24.0
7	2	Regional	O4WD	597	Robert Dupree	Michael Funk	1991 Mitsubishi Eclipse GSX	2:19:59.3
8	6	Regional	NA4WD	67	Jon Schrage	Nick Balzer	2007 Subaru Impreza	2:23:06.6
9	1	Regional	L4WD	396	David Matheson	Dominic Depaoli	1990 Other Talon TSI AWD	2:26:27.3
10	2	Regional	L4WD	432	Tom Mayer	Karl Mayer	2002 Subaru WRX	2:27:02.4
11	1	Regional	L2WD	986	Chris Nonack	Sara Nonack	2013 Subaru BRZ	2:28:40.9
12	1	Regional	O2WD	912	Scott James	Gavin James	2008 Volkswagen GTI	2:31:46.5
13	3	Regional	L4WD	993	Michael Tirpak	Nick Luther	1993 Ford Escort RS Cosworth	2:35:54.6
14	3	Regional	O4WD	810	Bradley Hayosh	Neil Moser	2002 Subaru Impreza STI	2:40:29.8
15	2	Regional	L2WD	633	Nick Bukky	Emmons Hathaway	2007 Honda Fit	2:42:15.2
16	3	Regional	L2WD	86	Tevfik Peker	Matt Soriano	2019 Ford Fiesta	2:44:02.7
17	7	Regional	NA4WD	449	Andrew Layton	Joe Layton	2004 Subaru Impreza	2:44:25.1
18	4	Regional	L2WD	787	Gabriel Nieves	Joseph Armstrong	2017 Honda Civic	3:03:45.9
		Regional	O4WD	992	Patrick Glodz	Michael Chmiel	2003 Mitsubishi EVOLUTION	1:41:04.1
		Regional	NA4WD	929	Nathan Coulter	Bryce Proseus	1990 Subaru Legacy 3.0Whoa	31:53.1
		Regional	L4WD	69	Gabe Jacobsohn	Kyle Roberts	2004 Subaru Impreza WRX STi	40:21.3





# THANK YOU

The Sno\*Drift organizers wish to thank the citizens, elected officials, staff, businesses, and the communities of Montmorency County for their continued commitment to hosting the Sno\*Drift Rally. Please remember to support our local advertisers you see in this guide when you visit Montmorency County!

We recognize and thank those who have supported and contributed gifts for the many volunteers that make this event possible.

And finally; the most sincere **Thank You** to all our volunteers, often standing in the cold for hours, to make this event happen!

